



4 Ryland Close, Tetbury, Gloucestershire, GL8 8TF

£1,400 pcm

Situated in a small close on the edge of town, a modern semi detached house with a lovely kitchen, large open plan living/dining room, 3 bedrooms and new bathroom.

01666 840 886 jamespyle.co.uk interested@jamespyle.co.uk

4 The Old School, High Street, Sherston SN16 0LH
James Pyle Ltd trading as James Pyle & Co. Registered in England & Wales No: 08184953
VAT Reg No: 142054549



The Property

DESCRIPTION 4 Ryland Close is a semi-detached modern house, situated in a small close of similar homes on the edge of this thriving town within easy walking distance to many amenities.

The property is built of reconstructed Cotswold stone under a tiled roof whilst the light and spacious accommodation comprises a lovely new fitted kitchen, separate utility room/downstairs toilet and an impressive open plan living/dining room with patio doors opening to the rear garden.

On the first floor there are two excellent sized double bedrooms, a good sized single bedroom and recently refitted family bathroom.

Externally, there is parking to the front and a side access leading to the pleasant rear garden which is mainly lawn.

SITUATION Tetbury is a thriving and historic market town situated within an Area of Outstanding Natural Beauty surrounded by delightful Cotswold Countryside. The town centre offers a broad range of shops and amenities for everyday needs as well as a number of quality antique shops, excellent hotels, restaurants and cafes. Further everyday needs include a large

supermarket, hospital, surgeries and post office whilst there are also excellent schools catering for all ages.

Conveniently located less than half an hour from both the M4 and M5 motorway, Tetbury is within easy reach of Cirencester, Cheltenham, Bath, Bristol and Swindon. Close by is the beautiful Forestry Commission run Westonbirt Arboretum, as well as Westonbirt Prep and all girls boarding school, and Prince Charles Highgrove Estate. There is good access to nearby Kemble Railway Station which provides regular fast services to London and other regional centres.

Directions

From the centre of Tetbury, head up London Road passing Tesco stores and garage and at the second mini roundabout turn left into Shepherds Mead. Rylands Close is then the second turning on the right hand side. Sat Nav GL8 8TF

Local Authority

Cotswold District Council

Council Tax

C £1,929

EPC Graph to follow

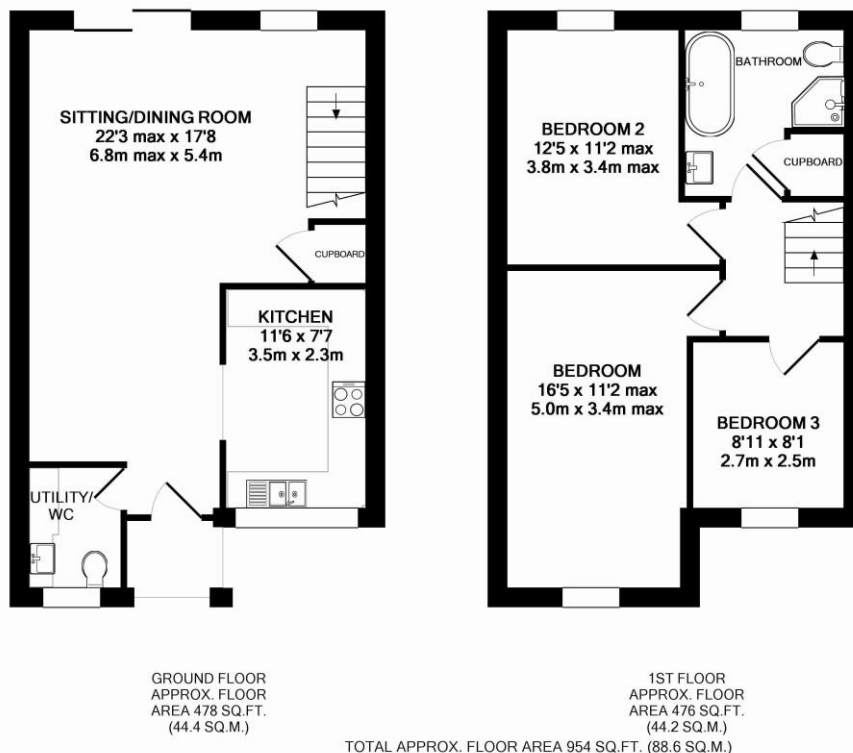

Whilst every attempt has been made to ensure the accuracy of the floor plan contained here, measurements of doors, windows, rooms and any other items are approximate and no responsibility is taken for any error, omission, or mis-statement. This plan is for illustrative purposes only and should be used as such by any prospective purchaser. The services, systems and appliances shown have not been tested and no guarantee as to their operability or efficiency can be given
Made with Metropix ©2015